



South Grove Primary School

April 2022

Dear Parents,

CHANGES TO THE ORGANIZATION OF SOUTH GROVE FOR THE SUMMER TERM

Thank you all for your patience and cooperation during the last few months regarding entering and leaving the school building safely due to COVID-19 arrangements and advice from Public Health.

You will be pleased to know that we intend to return to the following arrangements:

THE SCHOOL DAY:

- The children from Years Reception to Year 6 will return to the normal school day of 8:45am to 3:15pm
- Nursery times will be 8:50am -11:50am and 12:20pm – 3:20pm

START OF THE SCHOOL DAY:

- **Years 1-6 parents** to drop off at any gate and the children come into the playground to line up on their own
- **PLM** children will line up at the School Office as normal
- **Reception** children to be taken through the Nursery Playground to the Reception Playground by their parents and line up outside of the classroom door. Please note that there will be no entrance to Reception playground through the KS1 playground.
- **Nursery** children to line up outside the Nursery door with their parents

ALL GATES WILL BE OPEN AND A MEMBER OF STAFF WILL BE ON DUTY AT EACH GATE

HOME TIME:

- **Years Reception to Year 6** will all finish at the same time of 3:15pm
- Parents can enter/exit any gate but there will be no entrance to the Reception playground through the KS1 playground.
- The children will be collected from the classrooms and parents need to wait in the playgrounds by the appropriate classroom door
- **Nursery** – the children will be collected from the Nursery door as normal

LUNCHTIMES AND THE DINING HALL:

- All children will now eat in the dining hall
- Children will be playing at lunchtime with their normal Key Stage

We are still waiting for further information from the Local Authority and Public Health. We will update you with any further changes when we return for the Summer Term.

Have a very happy Easter Break.

Best Wishes,

J. Maltwood

Julie Maltwood
Headteacher

All Year groups start and finish at the same time; 8.45am-3.15pm

AM DROP OFF; Years 1-6 -Still parents to drop off use any gate

Gates to open and be manned at 8.35am. *

1 member of each year group to be on duty with the line

PLM-Office REC-line up by wooden fence Nursery-line up outside nursery door

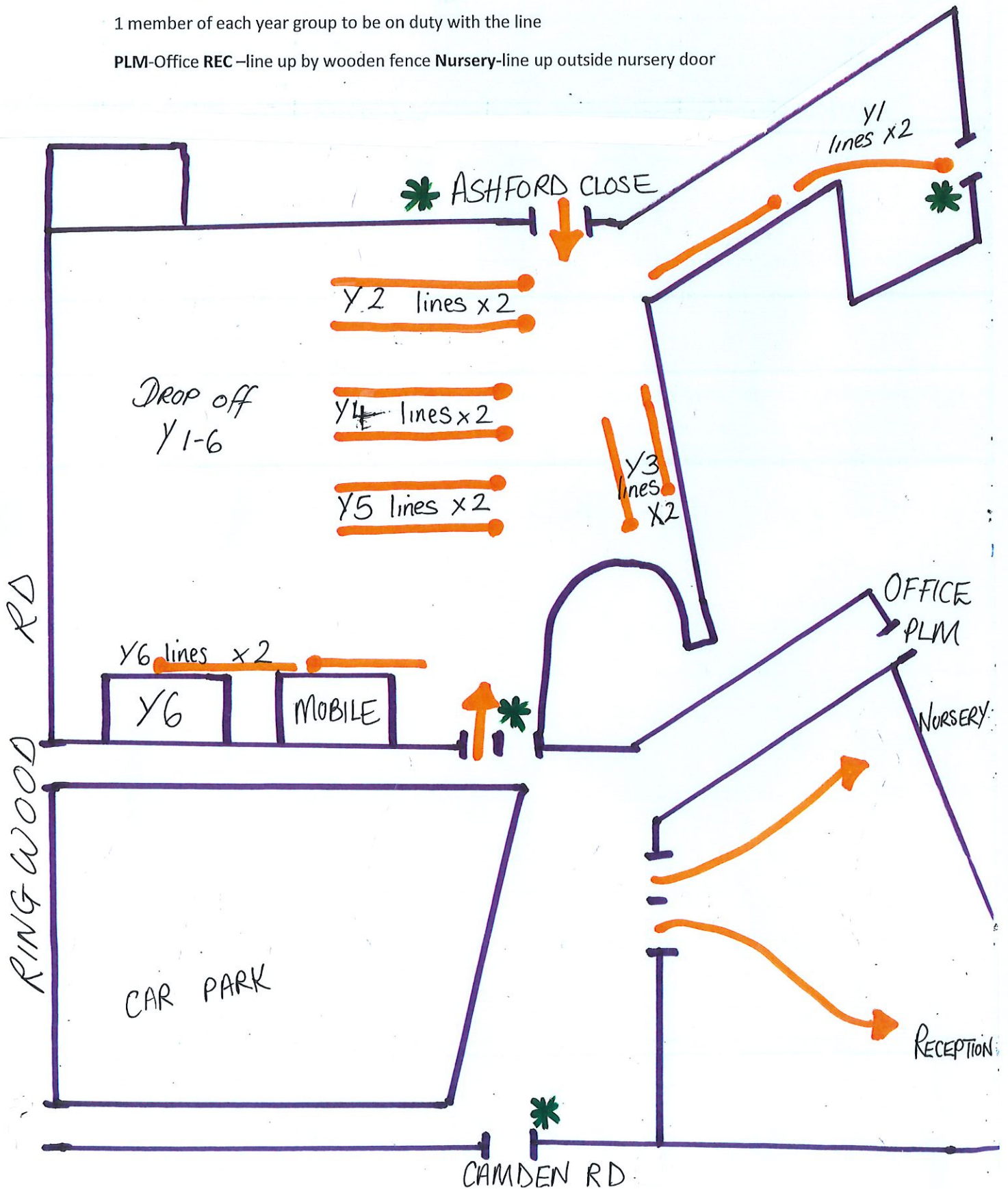

Home Time

All Finish at 3.15 Parents can enter/exit any gate

Gates to be manned. *

Collect children from classrooms.

